



Required Extra's

Each nursecall unit that needs to trigger a radio over door light must have the RODL-TX transmitter fitted



Description:

Though not used much in modern installations with full text location descriptions on displays, this ever popular device makes finding a service user in need of assistance even easier.

In principle each nurse call unit that needs to trigger a radio over door light would have the RODL-TX transmitter upgrade module fitted. Then when a call is activated the nursecall unit radio's the call to the control panel as normal, plus a short local transmission to the nearby over door light.

The radio over door light transmitter module upgrade for the nurse call units (RODL-TX) is a factory fitted option and must be specified at the point of ordering the equipment. It cannot be retro-fitted as a service option.

Technical Specification:

- o Up to 10 transmitters can be programmed to a RODL
- o High visibility twin bright LED's
- o 434Mhz transmission

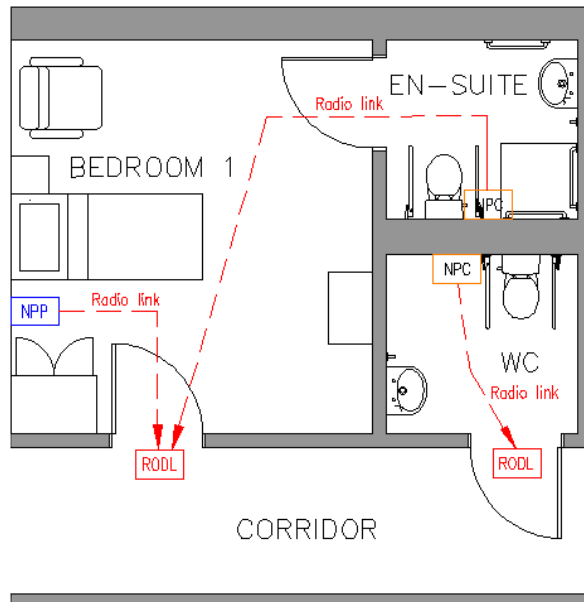

In pursuance of a policy of continued improvement, the company reserves the right to change the design and specification without prior notice

Supplier:

Radio Over Door Light

Alarm Radio Monitoring Ltd
Brunel Road
Enterprise Park
Leominster
HR6 0LX

Tel: 01568 610016
Fax: 01568 615511

E-mail:
sales@arm.uk.com

Website:
www.arm.uk.com